

NOTES:  
 Copyright in all documents prepared by the architect and any works executed from these documents and drawings, shall unless otherwise agreed, remain the property of the architect and must not be reproduced by, lent or disclosed to, a third party without the written consent of Good and Tillotson.

DO NOT SCALE OFF THIS DRAWING.  
 All dimensions to be checked on site and any discrepancies to be referred to the architect before proceeding.

ALL LEVELS TO BE CHECKED ON SITE.  
 All discrepancies between information shown on the drawings and the information in the specification to be referred to the architect before proceeding.

All component sizes and references to be checked prior to the ordering of materials.

Positions and designation (i.e. combined, surface water or foul) of existing drain runs on site are to be checked / confirmed by the building contractor prior to commencement of any drainage works. Any existing drains, to which additional connections are to be made, are also to be checked as necessary to ensure they are suitable to accommodate additional capacity and the type of effluent being connected.

All relevant boundary positions are to be checked prior to proceeding.

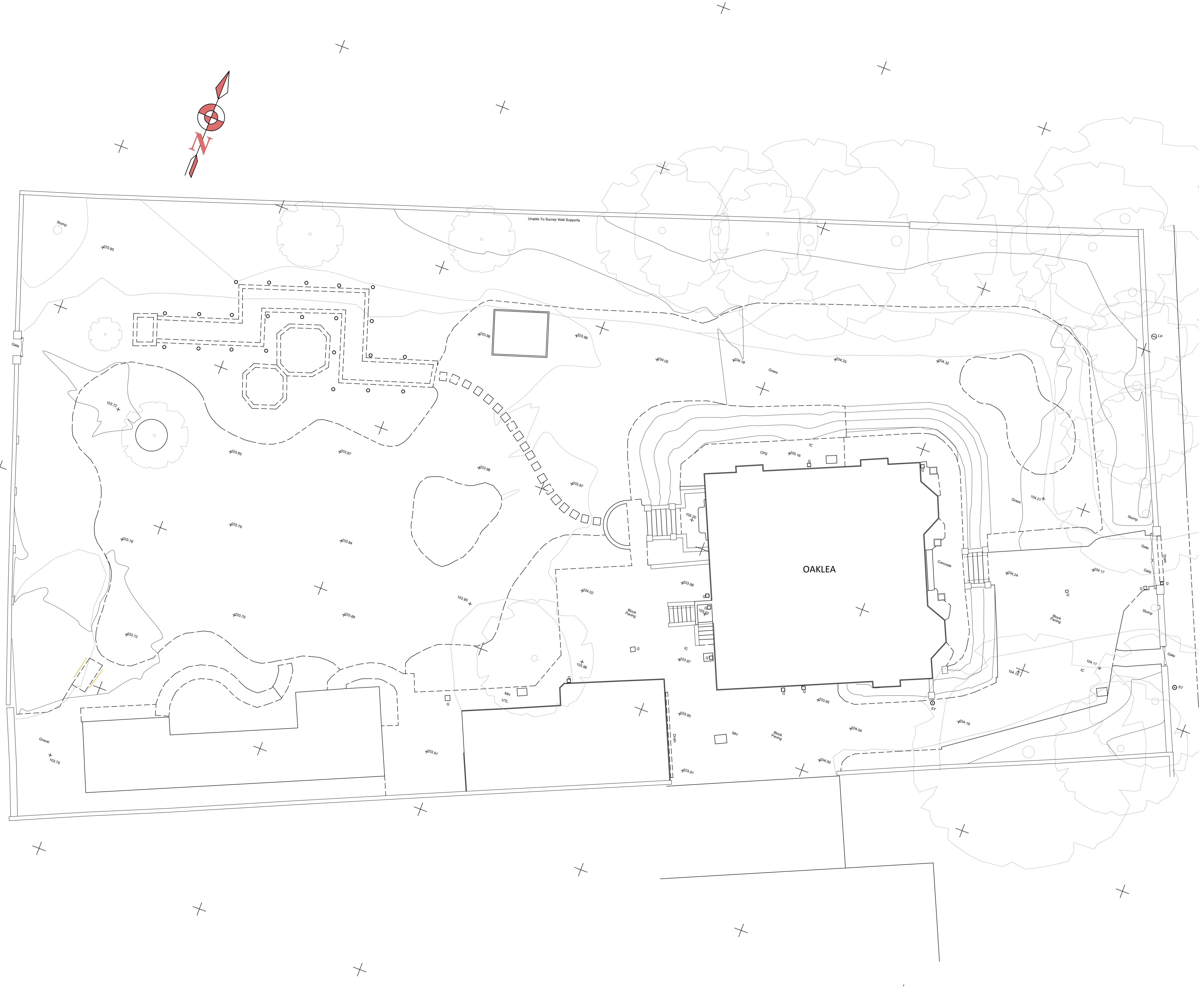
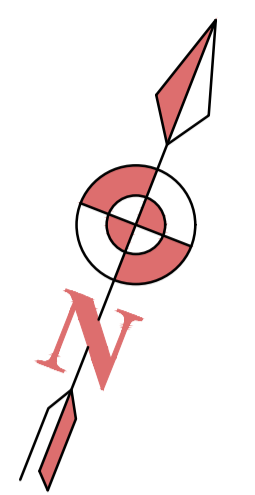

Rev	Revision	Int.	Date
Project:			
<b>Oaklea</b>			
Location:			
<b>Pleasington Lane, Pleasington</b>			
Employer:			
Client:			
<b>Mrs R Rothwell</b>			

**Good & Tillotson Chartered Architects**

2 The Studios,  
 318 Chorley Old Road,  
 Bolton,  
 BL1 4JU

Tel: 01204 497700  
 Email: info@goodandtillotson.co.uk  
 Web: www.goodandtillotson.co.uk



Drawing Title:  
**ExistingTopo Site Plan**

G&T Job No:	Scale:	Drawn:	Checked:	Date:
1704	1:100	LB	RW	15.01.18
Drawing Purpose:		Status:	Revision:	
Planning		S2	A1	
BIM Project:	Origin:	Zone:	Level:	Type:
1704-G&T-Z0-00-DR-A-0009				